



# Royal Industrial Suppliers

Quality Fasteners Specialist

No. 4, M.G.S. Complex, Benki Nawab Street, S.P. Road Cross, Bangalore 560002

An ISO 9001:2015 Certified Co



8310165941 / 9008782885



sales@royalfastenersindia.com



www.royalfastenersindia.com

## SELF CLINCHING NUT

For SS Sheet Hardness upto HRB 90

CATALOGUE NUMBER: **R2S15**

**SS HARDENED**

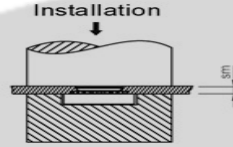
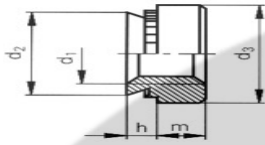

| Parameter ↓                          | Size → |  | M2x0.4 | M2.5x0.45 | M3x0.5 | M3.5x0.6 | M4x0.7 | M5x0.8 | M6x1.0 | M8x1.25 | M10x1.5 |
|--------------------------------------|--------|--|--------|-----------|--------|----------|--------|--------|--------|---------|---------|
| Collar dia d2                        | Max    |  | 4.22   | 4.22      | 4.22   | 4.73     | 5.38   | 6.38   | 8.72   | 10.47   | 13.97   |
| Nut dia d3                           | ±0.25  |  | 6.25   | 6.35      | 6.35   | 7.10     | 7.87   | 8.64   | 11.18  | 12.70   | 17.35   |
| Nut thickness m                      | ±0.25  |  | 1.50   | 1.50      | 1.50   | 1.50     | 2.00   | 2.00   | 4.08   | 5.47    | 7.48    |
| Hole size in sheet                   | +0.08  |  | 4.25   | 4.25      | 4.25   | 4.75     | 5.40   | 6.40   | 8.75   | 10.50   | 14.00   |
| Minimum edge distance to hole centre |        |  | 4.80   | 4.80      | 4.80   | 5.60     | 6.90   | 7.10   | 8.60   | 9.70    | 13.50   |

Send your Orders / Enquiries along with the following Item Codes

All Dimensions are in MM

| Size ↓     | Param →<br>Shank Code ↓ | Part Number | Min Sheet Thk sm | h (Shank) Max | PRESS IN (Installation) lbs |           | PUSH OUT lbs |       | TORQUE OUT lb |       |
|------------|-------------------------|-------------|------------------|---------------|-----------------------------|-----------|--------------|-------|---------------|-------|
|            |                         |             |                  |               | Aluminium                   | Steel     | Aluminium    | Steel | Aluminium     | Steel |
| M2x0.4     | 0                       | R2S1500200  | 0.80             | 0.77          | 6.7-8.9                     | 11.2-15.6 | 280          | 470   | 0.90          | 1.47  |
|            | 1                       | R2S1500201  | 1.00             | 0.97          |                             |           | 400          | 550   | 1.13          | 1.70  |
|            | 2                       | R2S1500202  | 1.40             | 1.38          |                             |           | 750          | 1010  | 1.47          | 2.03  |
| M2.5x 0.45 | 0                       | R2S1520500  | 0.80             | 0.77          | 6.7-8.9                     | 11.2-15.6 | 280          | 470   | 0.90          | 1.47  |
|            | 1                       | R2S1520501  | 1.00             | 0.97          |                             |           | 400          | 550   | 1.13          | 1.70  |
|            | 2                       | R2S1520502  | 1.40             | 1.38          |                             |           | 750          | 1010  | 1.47          | 2.03  |
| M3x0.5     | 0                       | R2S1500300  | 0.80             | 0.77          | 6.7-8.9                     | 11.2-15.6 | 280          | 470   | 0.90          | 1.47  |
|            | 1                       | R2S1500301  | 1.00             | 0.97          |                             |           | 400          | 550   | 1.13          | 1.70  |
|            | 2                       | R2S1500302  | 1.40             | 1.38          |                             |           | 750          | 1010  | 1.47          | 2.03  |
| M3.5x0.6   | 0                       | R2S1530500  | 0.80             | 0.77          | 11.2-13.4                   | 13-26     | 280          | 490   | 1.80          | 2.30  |
|            | 1                       | R2S1530501  | 1.00             | 0.97          |                             |           | 400          | 570   | 2.30          | 2.71  |
|            | 2                       | R2S1530502  | 1.40             | 1.38          |                             |           | 800          | 1080  | 2.60          | 3.20  |
| M4x0.7     | 0                       | R2S1500400  | 0.80             | 0.77          | 11.2-13.4                   | 18-27     | 300          | 490   | 2.37          | 2.95  |
|            | 1                       | R2S1500401  | 1.00             | 0.97          |                             |           | 470          | 645   | 2.60          | 4.00  |
|            | 2                       | R2S1500402  | 1.40             | 1.38          |                             |           | 970          | 1250  | 4.00          | 5.10  |
| M5x0.8     | 0                       | R2S1500500  | 0.80             | 0.77          | 11.2-15.6                   | 18-38     | 300          | 530   | 3.00          | 3.60  |
|            | 1                       | R2S1500501  | 1.00             | 0.97          |                             |           | 480          | 800   | 3.60          | 4.50  |
|            | 2                       | R2S1500502  | 1.40             | 1.38          |                             |           | 845          | 1112  | 5.70          | 6.80  |
| M6x1.0     | 0                       | R2S1500600  | 0.038            | 0.040         | 11.2-13.4                   | 27-36     | 970          | 1380  | 7.90          | 13.00 |
|            | 1                       | R2S1500601  | 0.054            | 0.056         |                             |           | 1540         | 1760  | 10.20         | 17.00 |
|            | 2                       | R2S1500602  | 0.087            | 0.090         |                             |           | 1680         | 1850  | 14.10         | 19.20 |
| M8x1.25    | 1                       | R2S1500801  | 0.054            | 0.056         | 11.2-15.6                   | 27-36     | 1570         | 1870  | 13.60         | 18.70 |
|            | 2                       | R2S1500802  | 0.087            | 0.090         |                             |           | 1720         | 1980  | 18.10         | 20.30 |
| M10x1.5    | 1                       | R2S1501001  | 0.054            | 0.056         | 18-32                       | 32-50     | 1760         | 2020  | 32.70         | 36.20 |
|            | 2                       | R2S1501002  | 0.087            | 0.090         |                             |           | 1880         | 2150  | 36.20         | 39.60 |

Sizes in BLUE are non-preferred. Availability is limited and MOQ is higher.

Data is strictly informative.

Note: All Austenitic Stainless Steel Fasteners may exhibit some Magnetic Properties due to the Manufacturing Process.

Refer: ISO 3506-2 Annex F